



5,080 SF INDUSTRIAL BUILDING

\$1,350/MONTH

This 5,080 SF industrial warehouse with 12ft ceilings and a dock door is available for lease. The building is a wood frame with concrete block walls (cold storage building). It is zoned R-9, but designated industrial per the City of Newton. Landlord will pay for grounds maintenance.

123 W 23RD STREET

Newton

CONTACT FOR MORE INFORMATION

JAMES MITCHELL
Real Estate Broker

(828) 322-1723 | james@bhicp.com



BOYD & HASSELL
BHIC
INDUSTRIAL & COMMERCIAL PROPERTIES, INC.

PROPERTY HIGHLIGHTS & PHOTOS



Loading Dock Door



Interior of Warehouse



Dock Door & Warehouse



Office Space & Bathroom



200 FIRST AVENUE NW, SUITE 507, HICKORY, NC 28601

123 W 23rd St
Approximate Dimensions

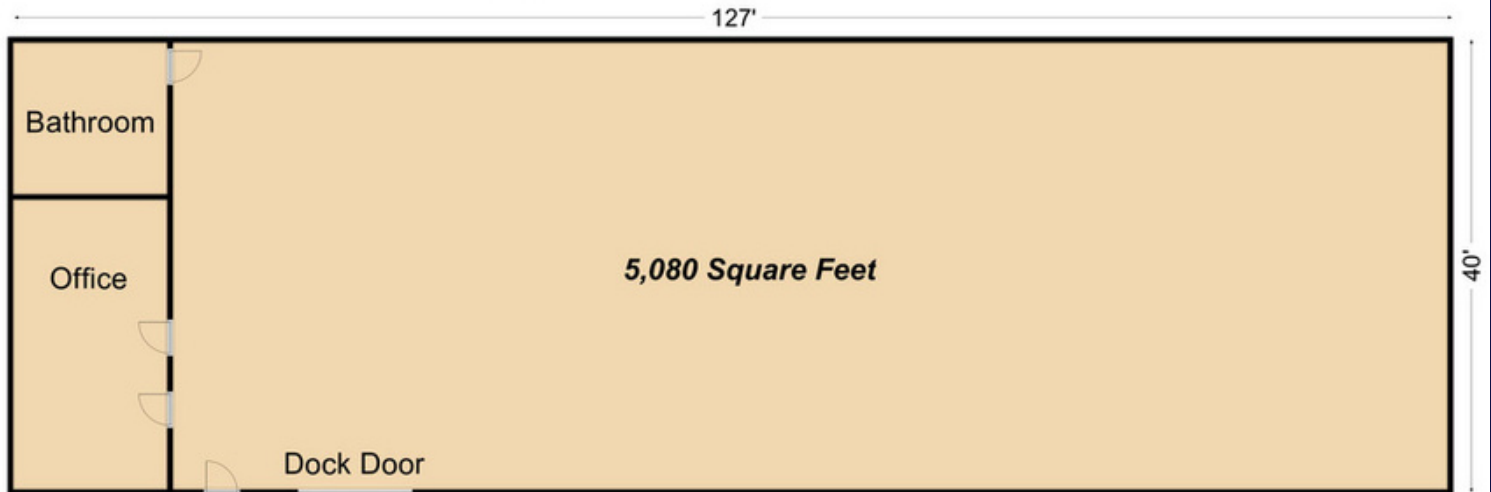

PROPERTY HIGHLIGHTS

- Bathroom
- Office
- Open Work Area
- Truck Loading Area
- Dock Door
- Gravel Parking





JAMES MITCHELL
Real Estate Broker

(828) 322-1723 | james@bhicp.com

